



## ProT5 UVB Kit / ShadeDweller ProT5



Safety, Installation and Maintenance Instructions

# ProT5

UVB Kit  
ShadeDweller®





# IMPORTANT

ENSURE THE UNIT IS SWITCHED OFF BEFORE INSTALLING THE LAMP

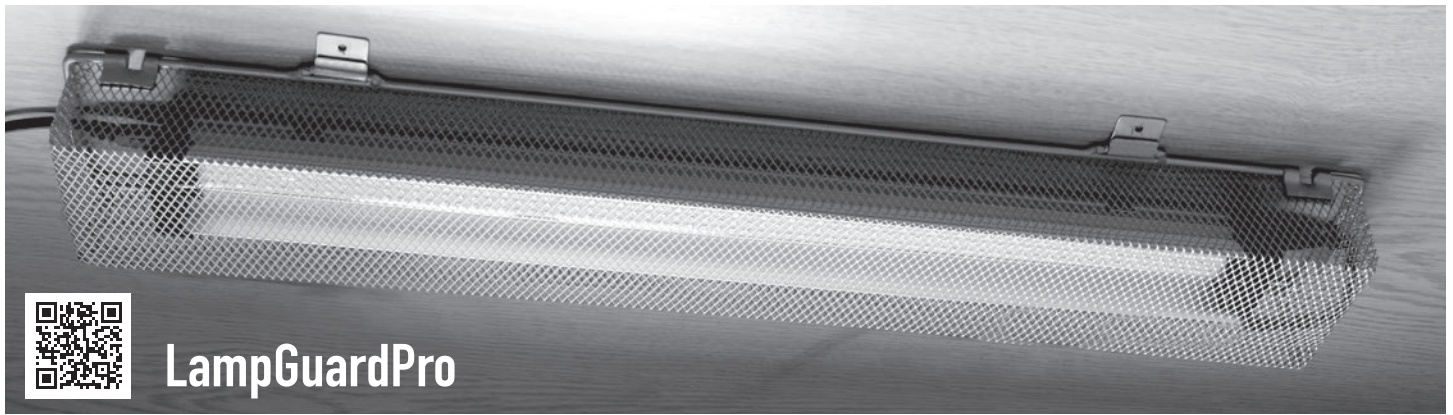

## LampGuardPro

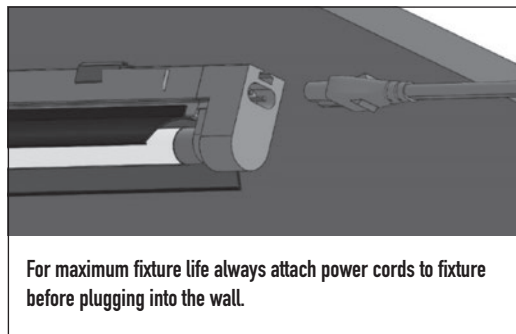
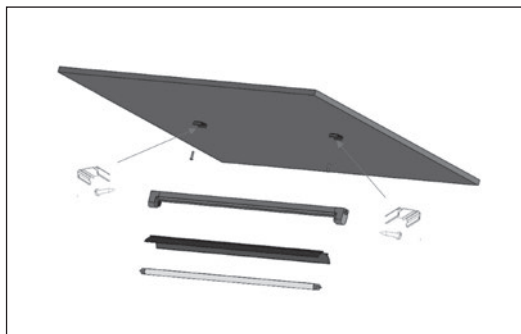

For maximum fixture life always attach power cords to fixture before plugging into the wall.

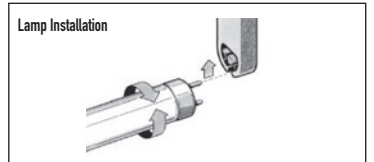
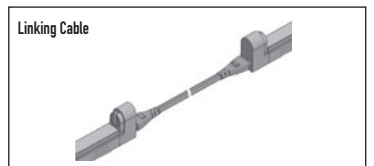

| LampGuardPro |              | ProT5 UVB KIT     |               | WATT      |
|--------------|--------------|-------------------|---------------|-----------|
| RALGP0       | 410mm / 16"  | RARTP8S/ RARTP8SA | 315mm / 12.5" | 8W        |
| RALGP1       | 660mm / 26"  | RARTP14S/ RARTP24 | 570mm / 22.5" | 14W / 24W |
| RALGP2       | 960mm / 38"  | RARTP39           | 870mm / 34"   | 39W       |
| RALGP4       | 1260mm / 50" | RARTP54           | 1170mm / 46"  | 54W       |

## SAFETY

Protects animals. Protects lamps.

Allows as much light as possible to travel into the vivarium.

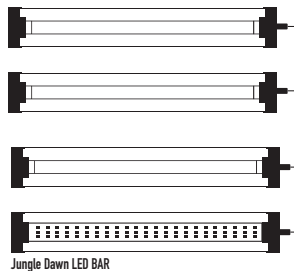

Minimum distance

|          |     |             |
|----------|-----|-------------|
| RARTP8S  | 8W  | 250mm / 10" |
| RARTP8SA | 8W  | 75mm / 3"   |
| RARTP14S | 14W | 100mm / 4"  |
| RARTP24  | 24W | 250mm / 10" |
| RARTP39  | 39W |             |
| RARTP54  | 54W |             |



## LINK CABLE / PROT5

The link cable will allow for up to 10 light units from one power source, including the Jungle Dawn LED BAR.

Jungle Dawn LED BAR

| Watt | Dragon   | Desert   | Forest   | Bird      |
|------|----------|----------|----------|-----------|
|      | 14% UV-B | 12% UV-B | 6% UV-B  | 2.4% UV-B |
| 24W  | RARTP24D | RARTP24R | RARTP24F | -         |
| 39W  | RARTP39D | RARTP39R | RARTP39F | -         |
| 54W  | RARTP54D | RARTP54R | RARTP54F | CARTP54B  |

| Watt | ShadeDweller | SD Arboreal | ShadeDweller Max |
|------|--------------|-------------|------------------|
|      | 7% UV-B      | 2.4% UV-B   | 2.5% UV-B        |
| 8W   | RARTP8S      | RARTP8SA    | -                |
| 14W  | -            | -           | RARTP14S         |

| Length    | 315mm / 12.5" | 570mm / 22.5" | 570mm / 22.5" | 870mm / 34" | 1170mm / 46" |
|-----------|---------------|---------------|---------------|-------------|--------------|
| Watt      | 8W            | 14W           | 24W           | 39W         | 54W          |
| kWh/1000h | 9             | 16            | 26            | 44          | 60           |

# KEEP THESE INSTRUCTIONS FOR FUTURE REFERENCE. READ AND FOLLOW ALL SAFETY INSTRUCTIONS.

**DANGER** - To avoid possible electric shock, special care should be taken if water is employed in the use of vivarium equipment. For each of the following situations, do not attempt repairs yourself; return the appliance to an authorised service facility or discard the appliance.

This product is designed for indoor use and the illumination of Vivariums and Aviaries only and will provide a good and safe service life, provided that these instructions are followed. Failure to do so may result in serious personal injury or property damage.

If you are in any doubt about the installation or operation of this product, please consult a qualified and experienced electrician.

Check that the voltage and frequency rating on the product label is the same as your electrical supply before proceeding further.

**WARNING-** To guard against injury, basic safety precautions should be observed, including the following:

- Disconnect from the mains supply socket before maintaining the Luminaire. Never pull on the cord to remove the plug from the socket, instead grasp the plug and pull to disconnect.
- The Luminaire can get HOT. Never touch the Luminaire while it is operating, allow adequate time for it to cool before attempting any maintenance.
- This luminaire is rated IP20 NOT waterproof so do not use above or around water.
- If electrical components of the appliance get wet unplug the appliance immediately. If the appliance shows any sign of water leakage disconnect from the power supply immediately.
- Do not operate the Luminaire with defective or faulty lamps – circuit damage may occur. Replace lamps promptly with a lamp of the correct type and wattage. It is advisable to keep spare lamps available.
- Do not use the appliance other than for its intended use. The use of non-Arcadia attachment or accessories is not recommended and may cause an unsafe condition.
- Do not install or store the appliance where it will be exposed to extremes of weather or temperatures below freezing.

## PHYSICAL INSTALLATION

Select a suitable site close to your electricity supply. Do not connect appliance to the mains supply socket during installation. For maximum fixture life always attach power cords to fixture before plugging into the wall. Ensure the unit is switched off before the lamp is installed. This appliance is for indoor use only. Ensure the appliance is kept in a ventilated area and away from other heat sources. Make sure that the light from the appliance is aimed within the vivarium.

Place the luminaire in the desired position either on top of the Vivarium mesh or screwed to the top of the Vivarium (2 screws not supplied).

Ensure the mains lead and the luminaire are kept well out of reach of animals that might bite or damage them.

## ELECTRICAL INSTALLATION

Before installing, ensure that the rated voltage and frequency of the Luminaire match that of your power supply, and that the mains lead plug is fully compatible with your mains supply socket. If in doubt, please return the unit to the point of purchase for verification.

Plug the luminaire into the mains socket.

A suitable plug in timer may be used with this product.

## TROUBLE SHOOTING

Lamps strike almost immediately at nearly full brightness (dependant on ambient temperature) and reach their operating temperature soon after. After switching the fluorescent lamps off, they can be switched on straight away.

If the Luminaire does not light:

- Check that the mains power is connected and switched on both at the wall (including Timer if used) and on the Luminaire.
- Check that the Luminaire plug is properly fused.
- Check that the Luminaire is rated for the same supply voltage that you are using.
- Check that the Lamps are of the correct wattage, type and length for the Luminaire.
- Check that the lamps are installed correctly.

## MAINTENANCE

**Cleaning:** Disconnect from the power supply and wait till the Luminaire is cool before cleaning, this not only avoids smears but also reduces the likelihood of any damage from moisture entering the Luminaire.

Both the appearance and performance of your Luminaire can benefit from regular cleaning. A damp cloth is normally adequate to clean the body.

## END OF USE RECYCLING INFORMATION

This product is covered by European Directive 2002/96/EC. Please do not dispose of this product or replacement lamps with your normal household waste. To safely and responsibly dispose of the product please ensure all the components are deposited in the appropriate areas of your local civic recycling centre. Proper disposal of this product helps to prevent potential negative consequences for the environment and human health.

All electronic components (this includes the power supply and the lamp holder) should be placed in the electronic waste recycling area.

If a fluorescent lamp is provided with this product it contains mercury, and cannot be disposed of with normal household waste; it should be deposited in the fluorescent lamp recycling area at your local civic recycling centre or taken to any approved recycling point for fluorescent lamps.



Class II Luminaire.  
Double insulated.



Do not look directly  
at light source.

Monkfield Nutrition Ltd.  
Arthur Rickwood Farm, Chatteris Road,  
Mepal, Ely, Cambs CB6 2AZ. United Kingdom  
info@arcadia-reptile.com

EU Authorised Representative:  
Comply Express LDA,  
StartUp Madeira EV41, Campus da  
Penteada, 9020 105 Funchal, Portugal.



**IP20 ✓RoHS CE**

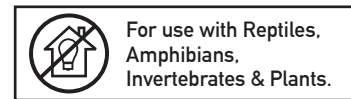

For use with Reptiles,  
Amphibians,  
Invertebrates & Plants.

JBR001